

RANDOLPH STREET

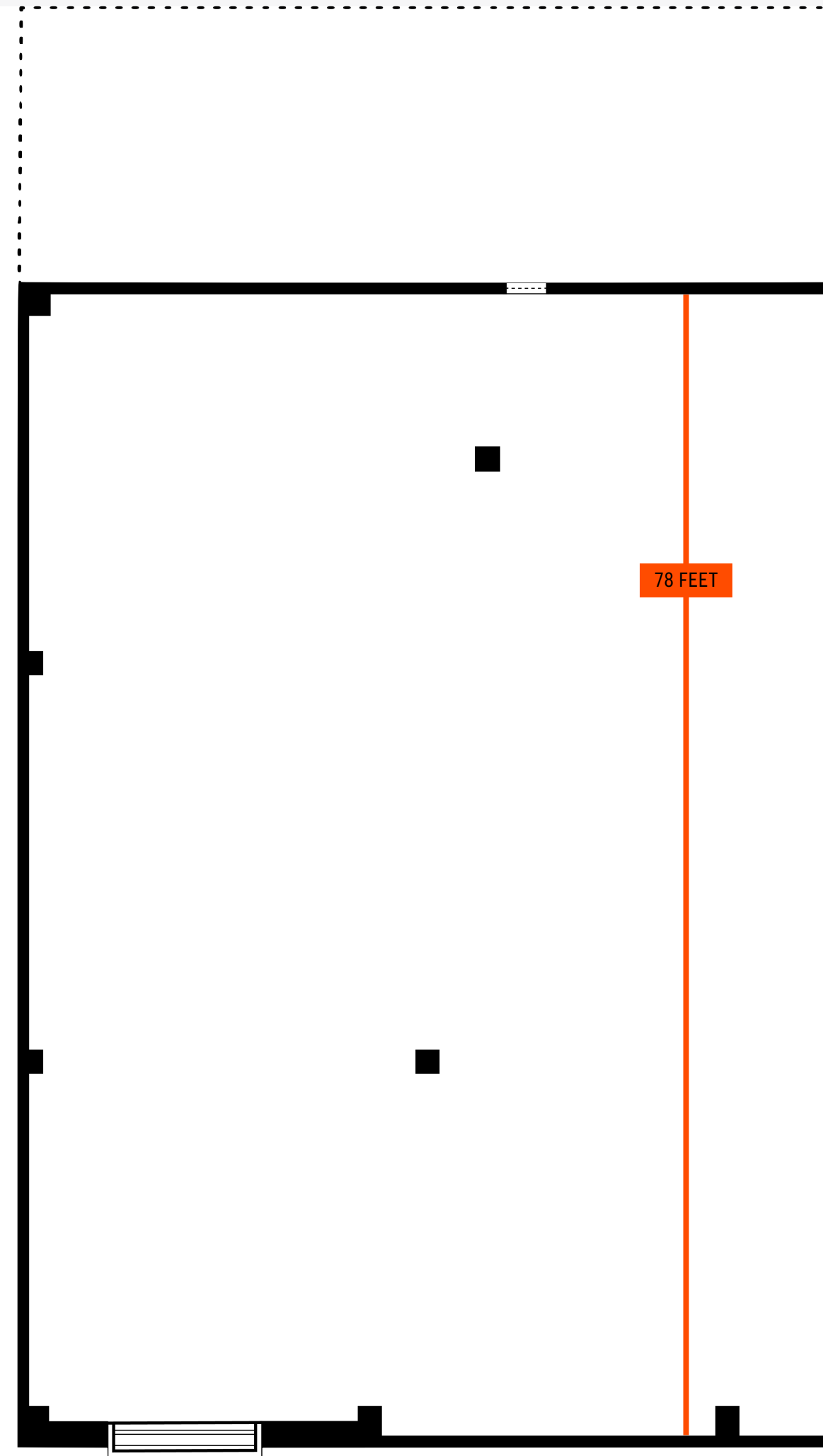

# SPACE B

**INTERIOR: 5,016 SF**  
**EXTERIOR: 1,132 SF**

- 19' HIGH CEILING HEIGHTS FROM THE SLAB TO THE UNDERSIDE OF THE ROOF
- 5' TALL CONTIGUOUS BAND OF WINDOWS THAT WRAP THE TOP OF THE FACADE (ACROSS RANDOLPH ST)
- 20' PAVED REAR SET BACK PROVIDING 1,132 SF OF OUTDOOR SPACE (PARKING, GREEN SPACE, OR ADDITIONAL STORAGE)
- FULL HEIGHT DRIVE IN ROLL UP GATE FEATURING 17'4" HIGH CLEARANCE - 20' WIDE EXTERIOR
- WELL MAINTAINED STEEL FRAMED STRUCTURE
- MASONRY NON-LOAD BEARING EXTERIOR WALLS
- HEAVY DUTY SLAB BETWEEN 8-10" OF CONCRETE THROUGHOUT FIRST FLOOR REINFORCED WITH WIRE MESH
- 25' - 28' ON CENTER COLUMN SPACING
- 200 AMPS OF 3 PHASE POWER
- 2 INFRARED HEATERS
- 2 INCH GAS LINE
- 2 INCH WATERLINE
- CODE COMPLIANT FULL COVERAGE WET SPRINKLER SYSTEM